

## CITYWAY in Rome



Designer: GIUGIARO DESIGN

### A full low-floor tram

In 1998, the Rome Transport Company, (Azienda dei Trasporti di Roma, ATAC), ordered 50 CITYWAY™ full low-floor trams as part of a renewal plan for the capital's urban transport network. These trams join the existing 28 partial low-floor CITYWAY™ trams already in commercial service.

CITYWAY™ trams are modular vehicles designed to offer the city a high capacity and passenger-friendly means of public transport.

Thanks to the clever tram

architecture, the vehicles are particularly agile in tight curves and therefore perfectly adapted to more arduous tram lines. Amongst other advantages, the trams' modular design significantly reduces lead times for the client.

The CITYWAY™ full low-floor tram for Rome is bi-directional and composed of three structural modules: the head body module, the trailer body module and the bridge-body module.

Two configurations are possible:

- a basic configuration with 7

modules and four doors on each side;

- an extended configuration, with 9 modules and six doors per side.

For both versions, floor height is 350 mm above track level.

The CITYWAY™ tram offers a range of possible interior arrangements. Interior design facilitates flow and safety for passengers, including the mobility impaired.

The result is a bright, functional and passenger-friendly vehicle.

## Diagram\*

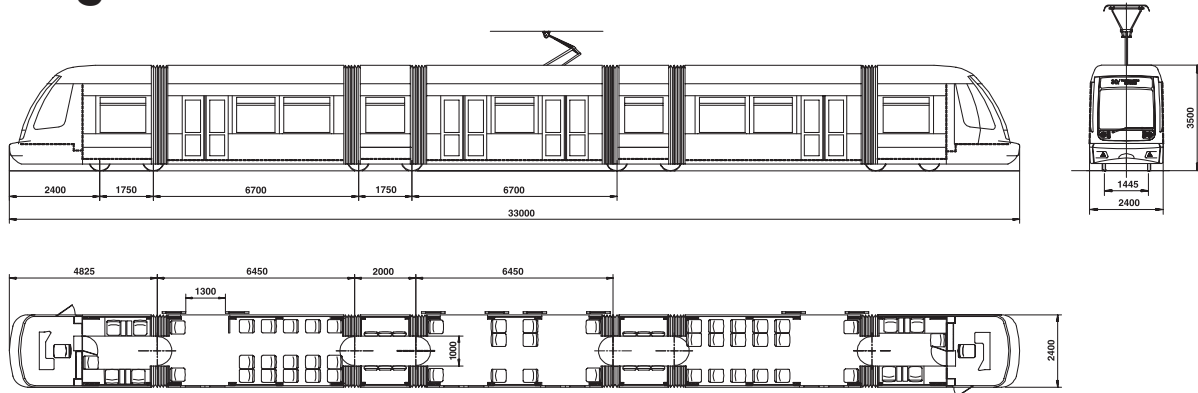

\* Colours do not represent CITYWAY™ in Rome livery

## Technical features

	Type of vehicle	Bi-directional - Full low floor
	Power supply	600 Vdc
	Track gauge	1445 mm
<b>Description</b>	Basic configuration	Extended configuration
Length	33 m	41.45 m
Width	2.4 m	2.4 m
Height	3.5 m	3.5 m
Access height	350 mm	350 mm
Floor height	350 mm	350 mm
Seated passengers	54	64
Standing passengers (4 pass / m <sup>2</sup> )	124	170
Total capacity	178	234
Door width (double doors)	1300 mm	1300 mm
Wheel arrangement	2 - Bo - Bo - 2	2 - Bo - Bo - Bo - 2
Maximum speed	70 kph	70 kph
Maximum power at wheels	732 kW	978 kW
Minimum vertical curve radius	200 m	200 m
Minimum curve radius in line	18 m	18 m
Minimum curve radius in storage yard	15 m	15 m
Specific provisions	Full air-conditioning	
	Air sprung suspension	
	Exterior/interior video surveillance system	

# ALSTOM

ALSTOM Transport - 48, rue Albert Dhalenne - 93482 Saint-Ouen - France

Tel.: 33(0)1 41 66 90 00 - Fax: 33(0)1 41 66 96 66

[www.transport.alstom.com](http://www.transport.alstom.com)